

# RS FORMULA V2

## ASSEMBLY INSTRUCTIONS RSEAT RS FORMULA V2 Tablet/Buttonbox/Shifter Upgrade Kit

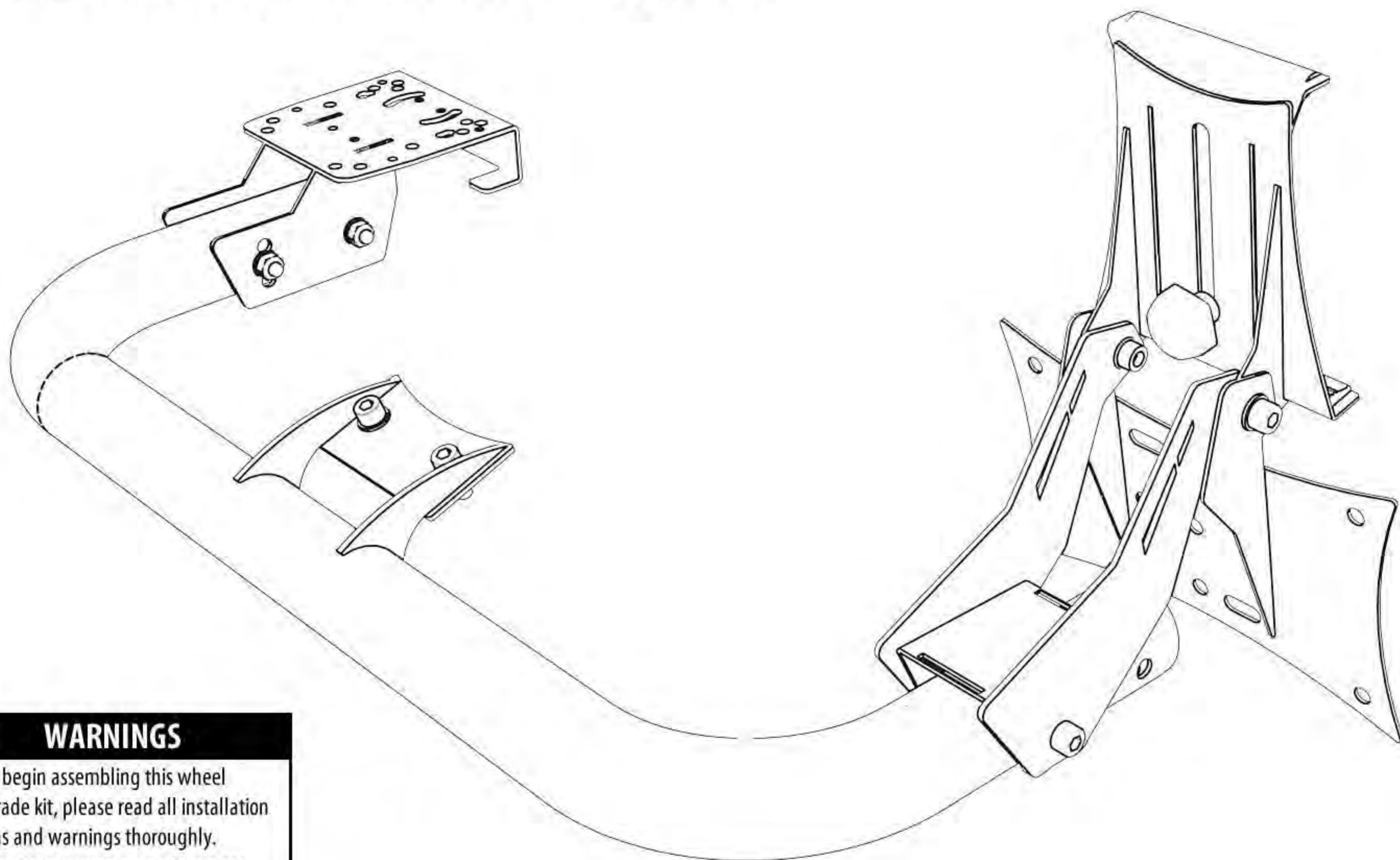

### **⚠** WARNINGS

Before you begin assembling this wheel stand upgrade kit, please read all installation instructions and warnings thoroughly.

**FAILURE TO COMPLY WITH OR OBSERVE ALL ASSEMBLY, SAFETY AND OPERATION INSTRUCTIONS AND WARNINGS REGARDING THE USE OF THIS PRODUCT MAY RESULT IN SERIOUS BODILY INJURY.**

This product complies with the prescribed safety regulations. Inappropriate use may cause damage to persons and wheel stand.

**1**

Assemble the RS Formula V2 upgrade kit as shown on the image. You can mount both the shifter and the tablet holder on left or right side.

**Please note!** Tighten the screws by hand. Tighten well all M8x20mm screws after the upgrade kit is completely assembled

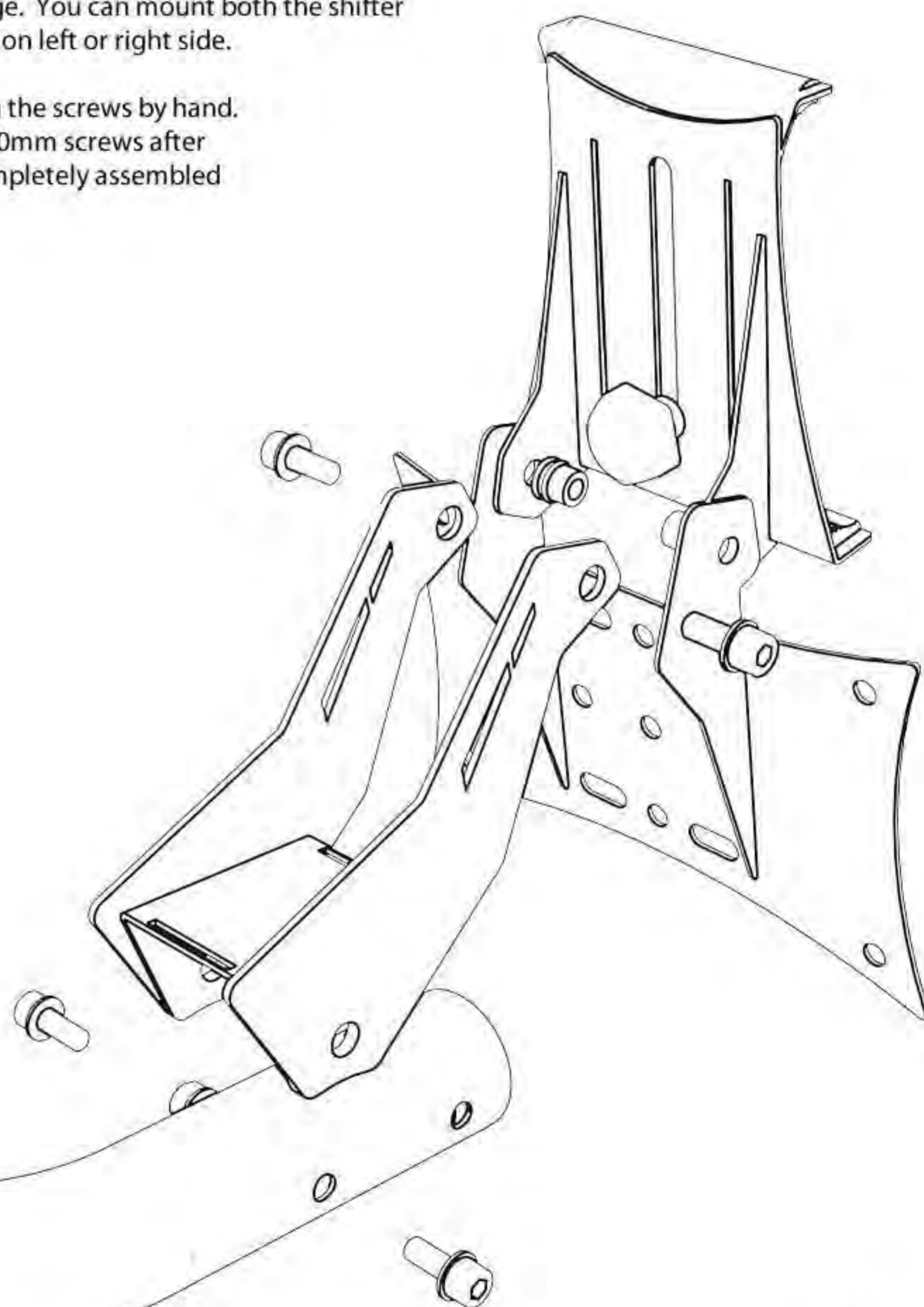
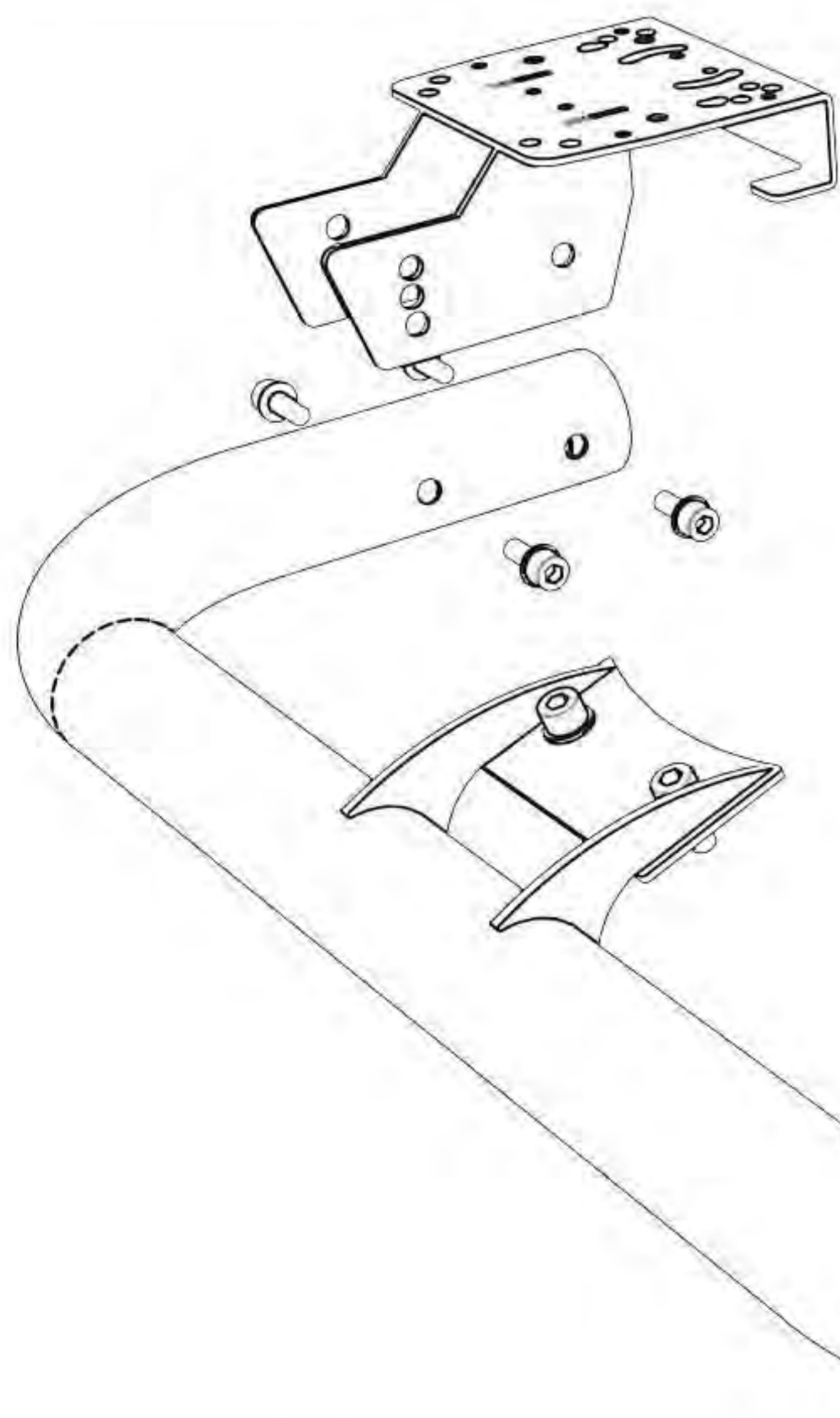



2

Assemble the RS FORMULA V2 Upgrade kit shifter and tablet arms as on the image below.

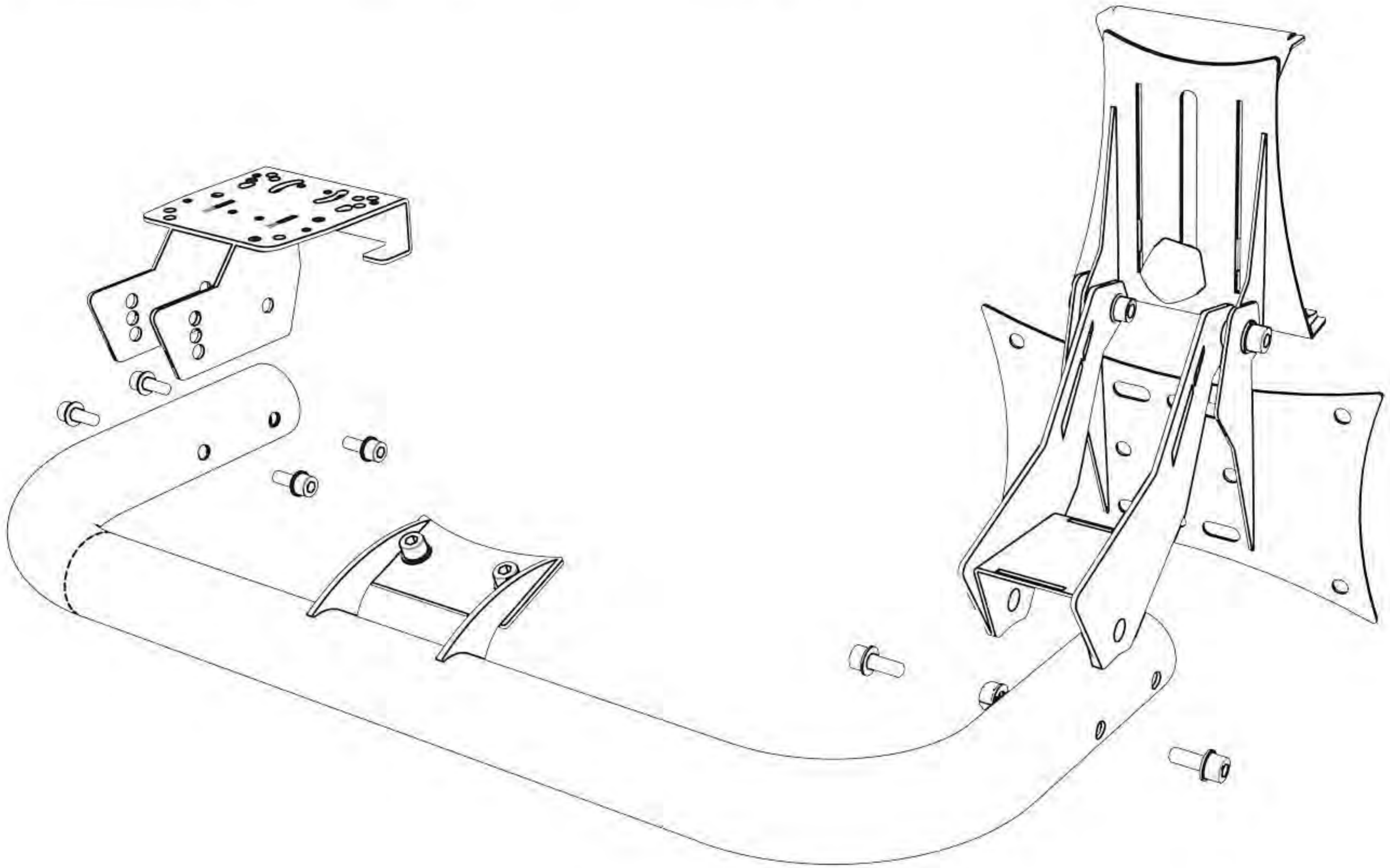

3

To lock the arms in place use the M8 X 20mm screws and tighten well. There are three fixed positions for the shifter tilt position to choose from.

