

# RS STAND T3XL V2

This instruction is developed to assist you in assembling of RSEAT T3XL V2 Triple screen TV stand

Language: **EN**

ASSEMBLY INSTRUCTIONS  
RSEAT RS STAND T3XL V2 3x32/47" TV's

**⚠ WARNINGS**

Before you begin assembling this tv stand, please read all installation instructions and warnings thoroughly.

**FAILURE TO COMPLY WITH OR OBSERVE ALL ASSEMBLY, SAFETY AND OPERATION INSTRUCTIONS AND WARNINGS REGARDING THE USE OF THIS PRODUCT MAY RESULT IN SERIOUS BODILY INJURY.**

This product complies with the prescribed safety regulations. Inappropriate use may cause damage to persons and tv stand.

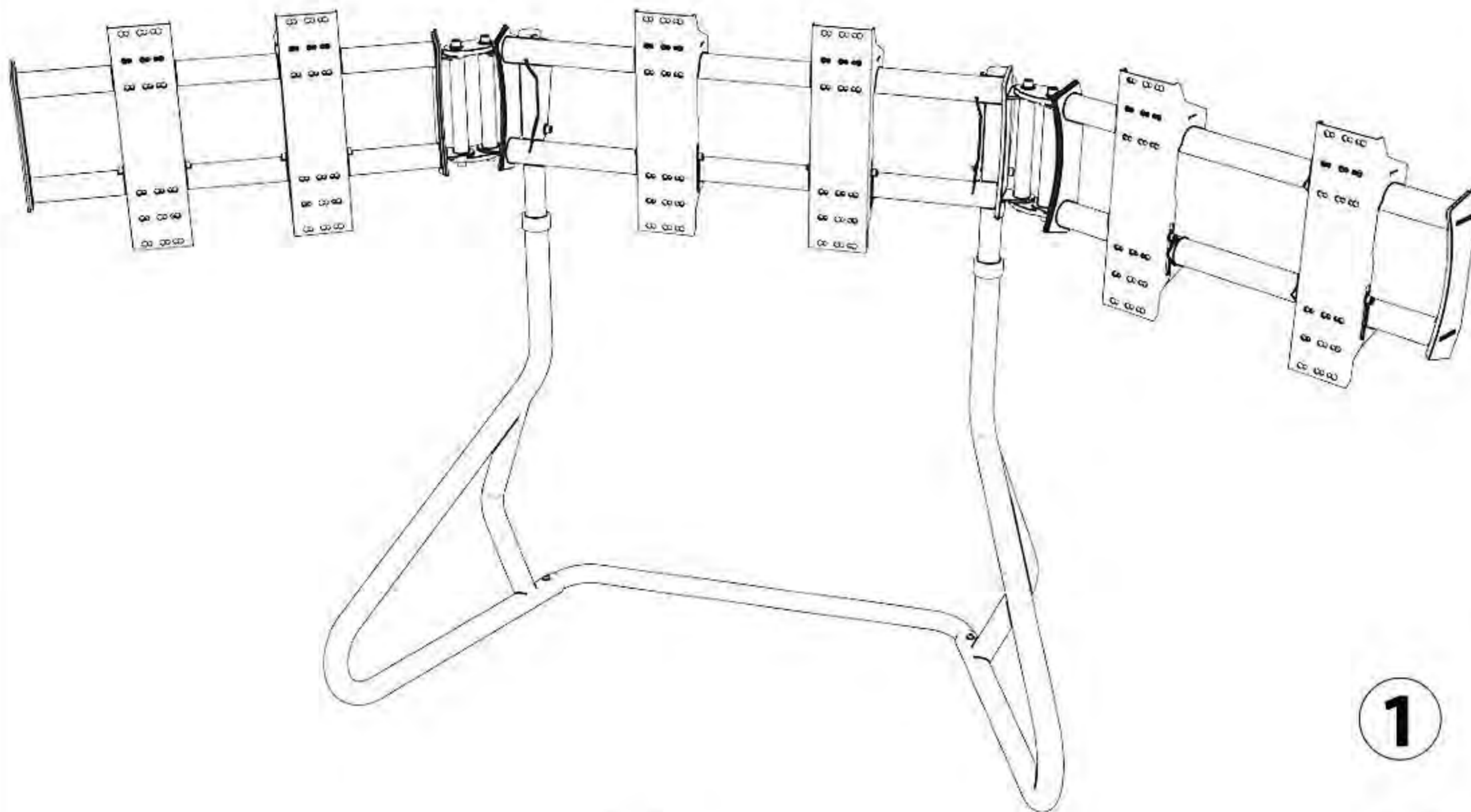

Put the parts on a flat surface. Assemble the stand hinges as shown on the image below. To lock the hinges just tighten the screws.

**1**

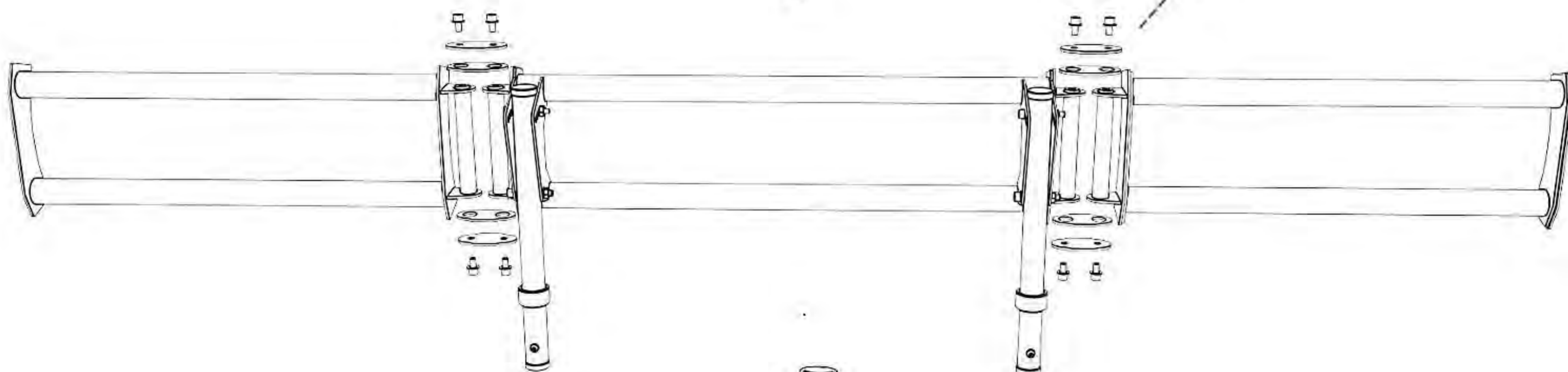

Assemble the legs as shown on the picture.

**2**

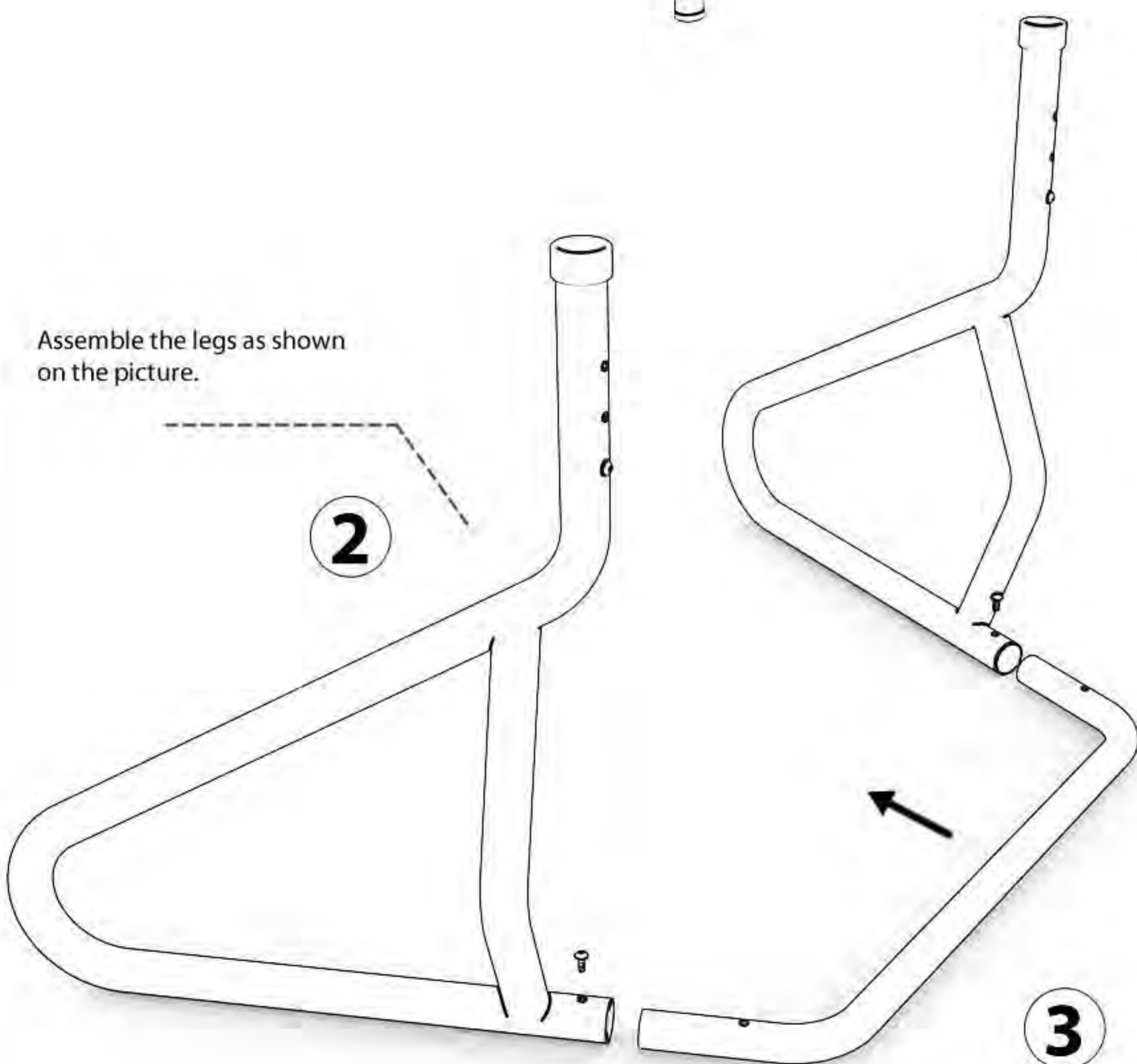

**3**

Assemble the legs with the stand as shown on the image.

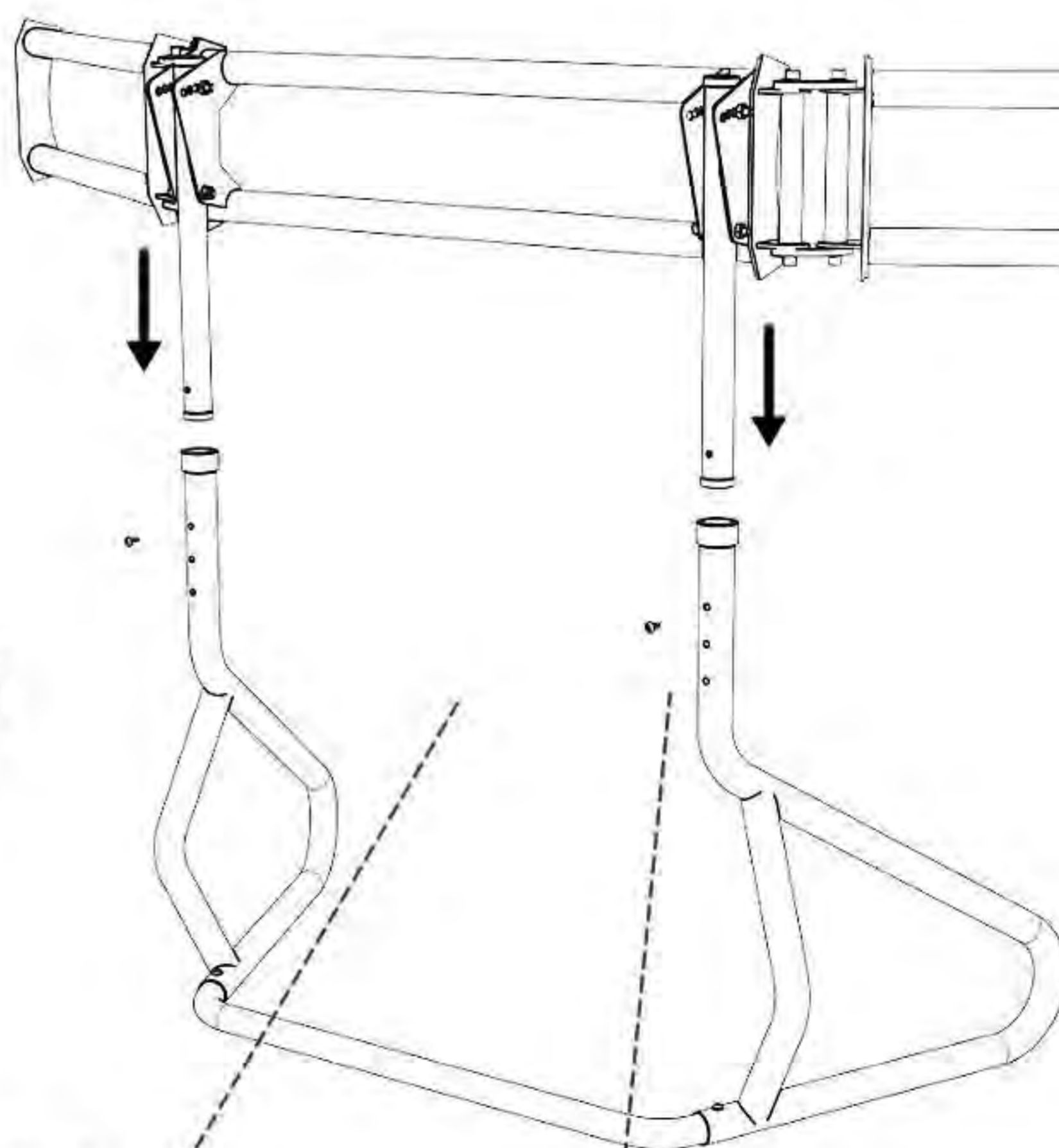

Set the stand's height and screw the fixation bolt

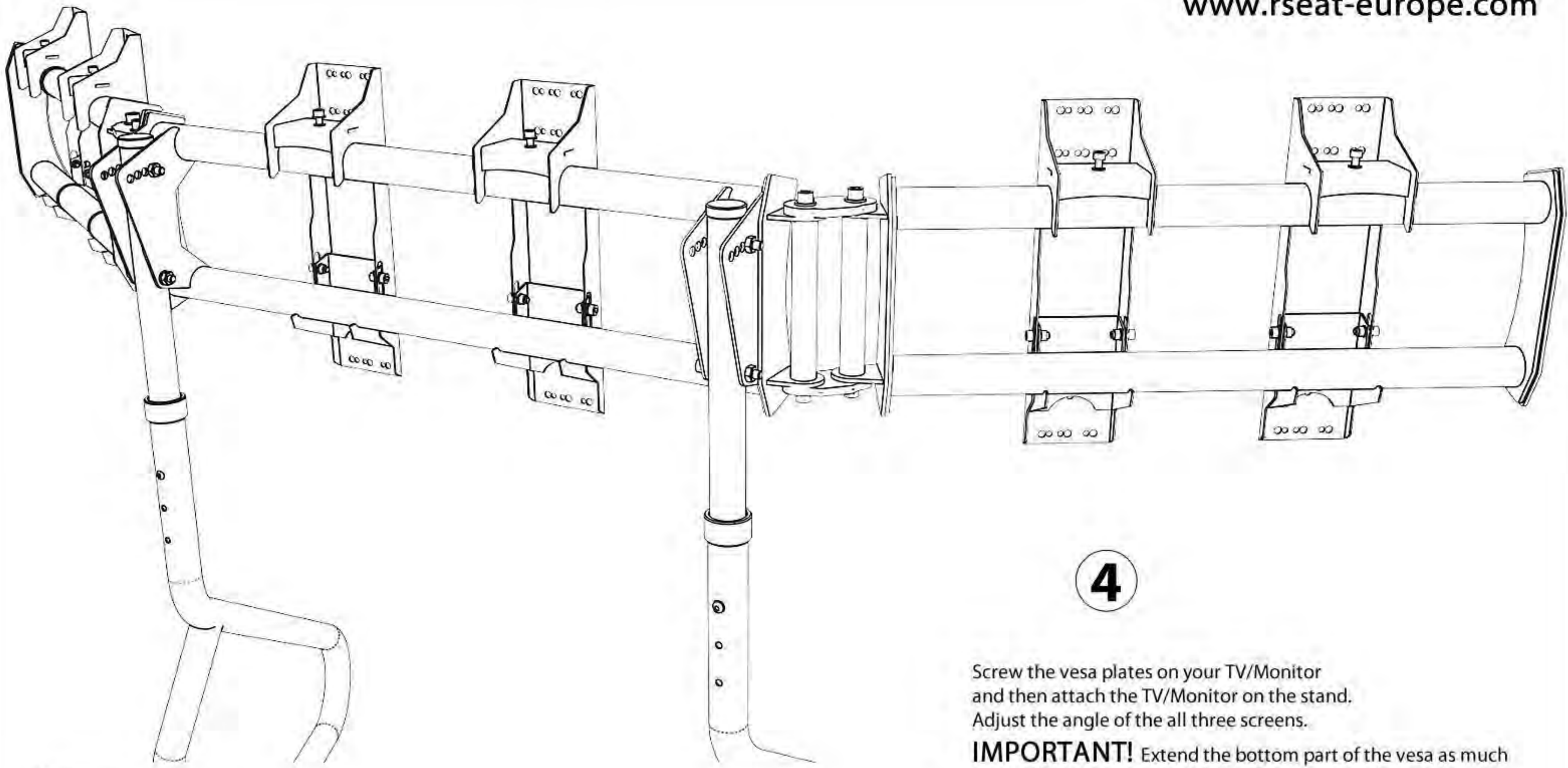

4

Screw the vesa plates on your TV/Monitor and then attach the TV/Monitor on the stand. Adjust the angle of the all three screens.

**IMPORTANT!** Extend the bottom part of the vesa as much as possible before you install the TV on the stand.

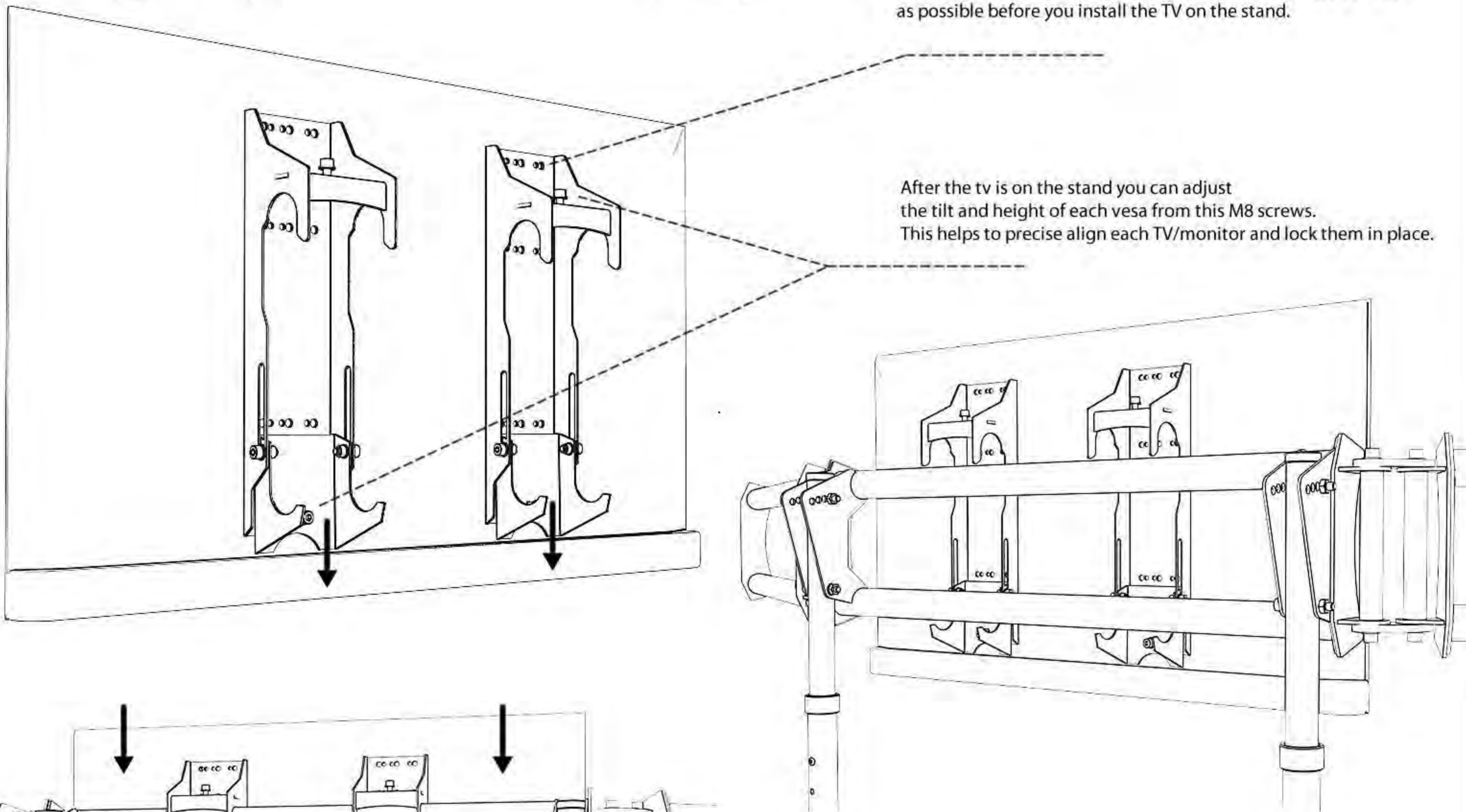

After the tv is on the stand you can adjust the tilt and height of each vesa from this M8 screws. This helps to precise align each TV/monitor and lock them in place.

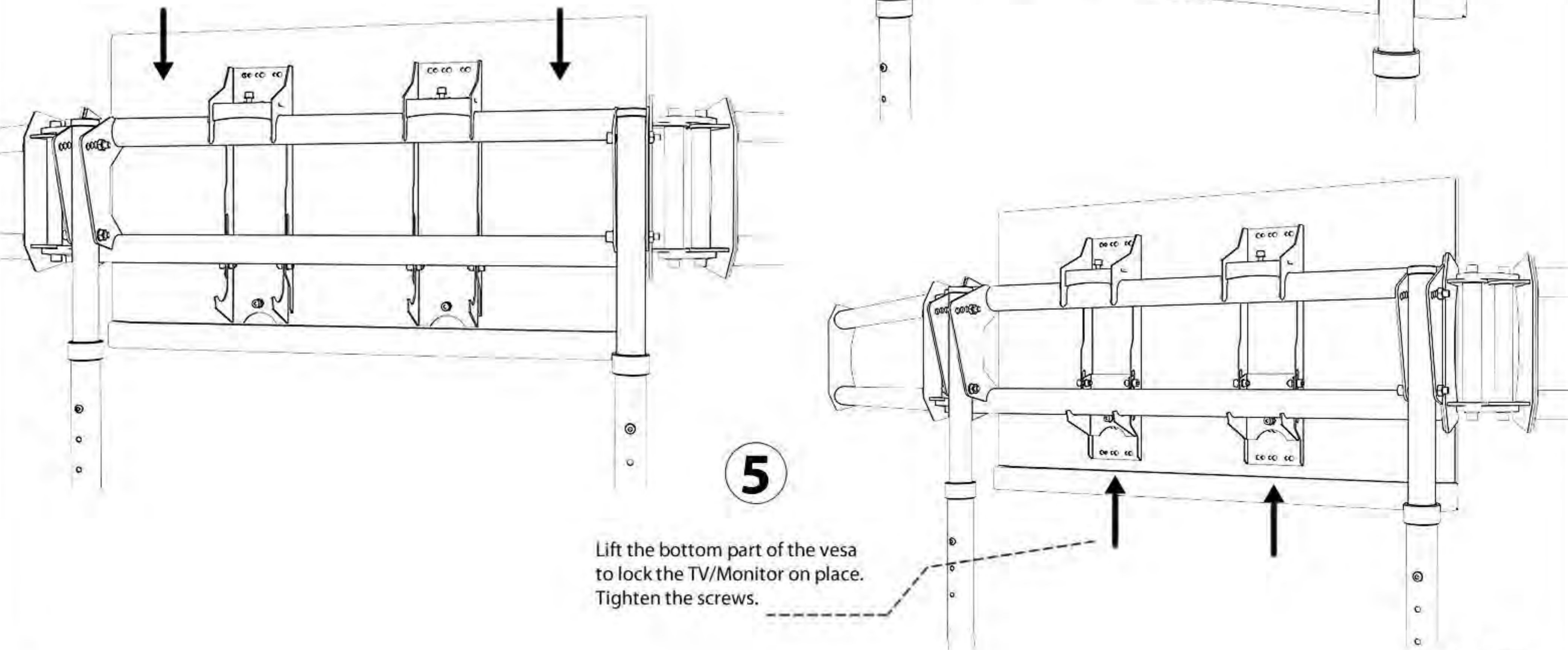

5

Lift the bottom part of the vesa to lock the TV/Monitor on place. Tighten the screws.